



AC35 ACOUSTIC DOOR

Fully **CE** compliant.
Tested to EN14351-1 product compliant standard

Robust Doors can offer a level of acoustic attenuation from 22 to 54dB by varying the infill of the doorblade and frames. The higher levels of acoustic performance are achieved with custom manufactured doorsets using four-sided frames and acoustic seals.

DOOR LEAF

- Thickness:** 56mm (27kg/m² blade only).
- Material:** 1.2mm corrosion resistant Zintec/Aluzinc sheets as standard, wide variety of colours and finishes available. Also Stainless Steel.
- Infill:** A mineral wool core.
- Construction:** Doorblade manufactured from two 1.2mm sheets lockformed together and lipped on three sides, by bonding steel skins around a rigid core, using a no-weld construction.

DOOR FRAME

- Construction:** Folded from 1.6mm Zintec/Aluzinc. Infilled with Mineral Wool. Screw and tab construction with 4no. adjustable fixing feet per jamb. The frame is fitted with 3no. Scandinavian style Lift-off stainless steel hinges.
- Profile:** Standard is Type C or optionally Type B.

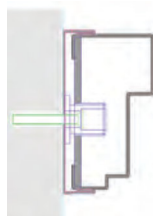

Type C

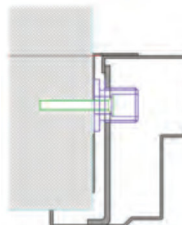

Type B

Click on images for full details.

THRESHOLD

Standard: Integral with frame.

Profile:

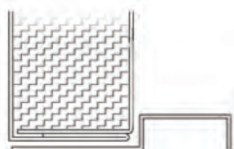

Standard

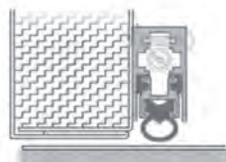

Drop Seal

lick on images for full details

Drop Seals are not suitable for Double Doorsets fitted with Panic hardware.

FINISHES

Standard: Polyester Powder coated from Standard Colour Range.

- Optional:** Polyester Powder Coating from non-standard colour range.
- PVC laminate from standard range.
- Woodgrain PVC laminate.
- Stainless steel, brushed, polished or patterned.
- Unfinished for site finishing.

SIZES

- Size:** Doors are custom manufactured in 10mm increments for single openings 690mm to 1200mm and double openings 1290mm to 2400mm, at heights up to 2700mm. Contact the Sales office for special configurations and finishes.



ACOUSTIC





ACOUSTIC PERFORMANCE

Rating: According to BS EN ISO 717-1:1997

$R_w(C;C_{tr}) = 45 (-3;-9)$ dB

Frequency (Hz)	R One-third octave (dB)
50	22.5
63	25.2
80	28.0
100	21.9
125	18.3
160	18.4
200	23.8
250	31.5
315	36.6
400	38.9
500	38.8
630	36.9
800	36.4
1,000	37.6
1,250	35.2
1,600	36.5
2,000	39.1
2,500	41.5
3,150	41.8
4,000	39.2
5,000	38.8

x R adjusted for filler wall

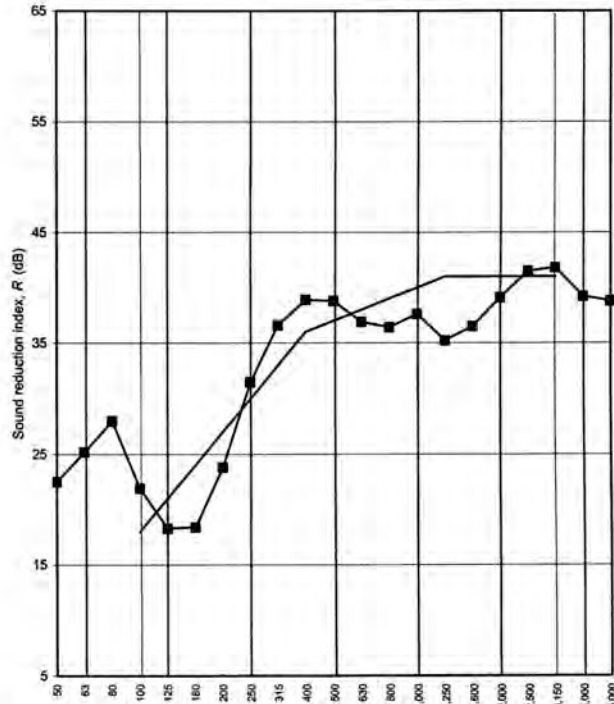

Notes:

1. The above performances were tested by the BRE on 7th March 2006, test report 228403.
2. Tested to BS EN ISO 140-3: 1995
3. Single number quantities calculated in accordance with BS EN ISO 717-1:1997
4. The tests were undertaken on doors up to 2100mm in height only. Robust cannot certify performance above that.
5. The tests are conducted on single doors only and values for double doors are extrapolated from the single values.



ROBUST UK LTD. Sutherland Road, Longton, Stoke-on-Trent, Staffordshire, ST3 1HZ
Tel: +44 (0)1782 592 900 • Fax: +44 (0)1782 592 901 • Email: sales@robust-uk.com

Individual specifications may vary as Robust conduct a policy of continuous product development.